



Data Sets (No. of Sensors)

| | |
|----------|----|
| Caliper | 12 |
| Odometer | 2 |

Physical Attributes

| | |
|--------|----------------|
| Length | 30 in (762 mm) |
| Weight | 65 lb (29 kg) |

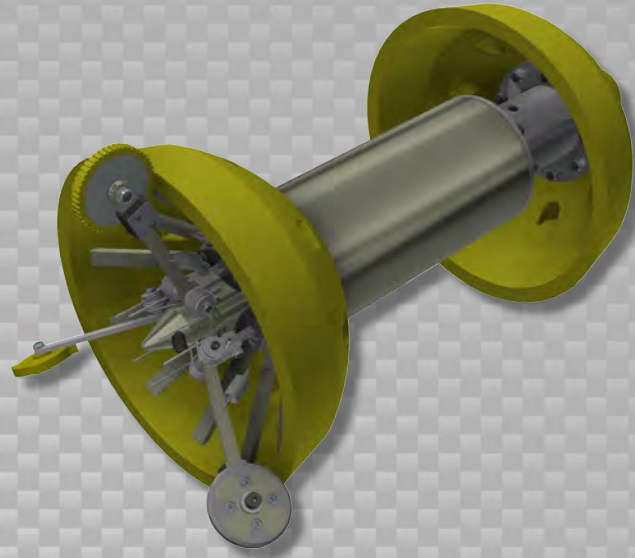

Operational

| | |
|---|------------------------------|
| Maximum Pressure | 1500 psi (10342 kPa) |
| Temperature Range | 32° to 140°F (0° to 60°C) |
| Velocity (Preferred) | 0.1 to 9 mph (0.04 to 4 m/s) |
| Minimum Required Diff. Pressure (Launching) | 50 psi (345 kPa) |
| Minimum Required Diff. Pressure (Running) | 40 psi (276 kPa) |

Pipeline Geometry Requirements

| | |
|---|-------------------|
| Minimum Cross Section Diameter | 10.50 in (267 mm) |
| Minimum Bend Radius | 1.5D |
| Minimum Bend Separation (1.5D Bends) | Back to Back |
| Minimum Tee Separation (Centerline to Centerline) | 32 in (813 mm) |

Reporting

| | |
|---|------------------|
| Dent/Ovality Sizing | |
| Dent Depth Sizing | 0.16 in (4.1 mm) |
| Ovality ID Reduction Accuracy | 0.16 in (4.1 mm) |
| Location Accuracy | |
| Feature to Upstream Girth Weld | ±1 in (25 mm) |
| Feature Orientation | ±15° |
| Bend Data | |
| Angle Accuracy | ±2° |
| Axial Sampling | |
| Depends on Speed, Line Condition & Length | 0.1 in (2.5 mm) |

Suggested Minimum Trap Dimensions (Contact Enduro For Minimum DfL-Combo Trap Dimensions)

| Traps | A | B | C | D | E | F | G | H |
|-----------------|-----------------|-----------------|----------------|----------------|-----------------|------------------|----------------|---------------|
| Launcher | 42 in (1067 mm) | 15 in (381 mm) | 18 in (457 mm) | 16 in (406 mm) | 62 in (1575 mm) | 102 in (2591 mm) | 14 in (356 mm) | 4 in (102 mm) |
| Receiver | 42 in (1067 mm) | 42 in (1067 mm) | 18 in (457 mm) | 16 in (406 mm) | 62 in (1575 mm) | 102 in (2591 mm) | 14 in (356 mm) | 4 in (102 mm) |

Notes

- Data quality and run success is dependent on tool speed & line conditions
- Pipelines that are outside of the scope of these specifications can be assessed on an individual basis
- Tool design may vary from image above
- ²Contact Enduro for details

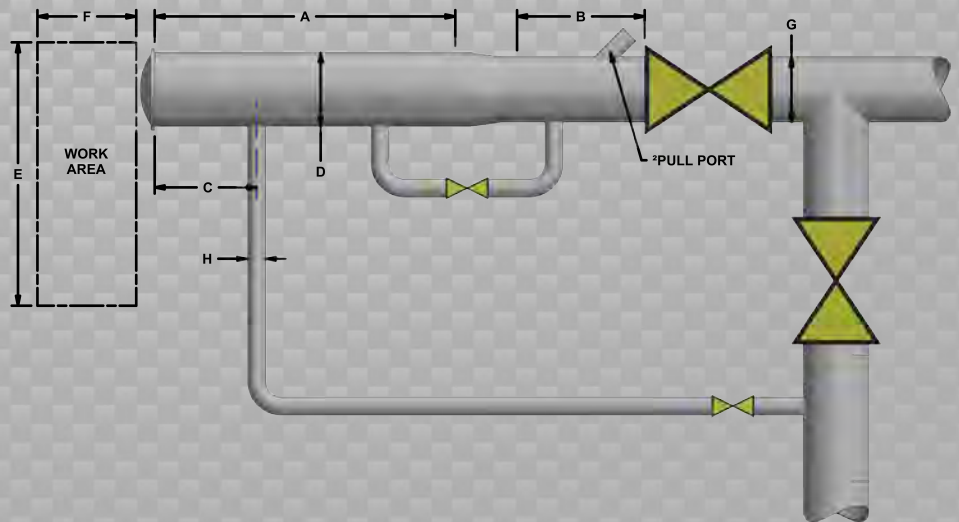

14" DdL